

PARKING  
NO PARKING

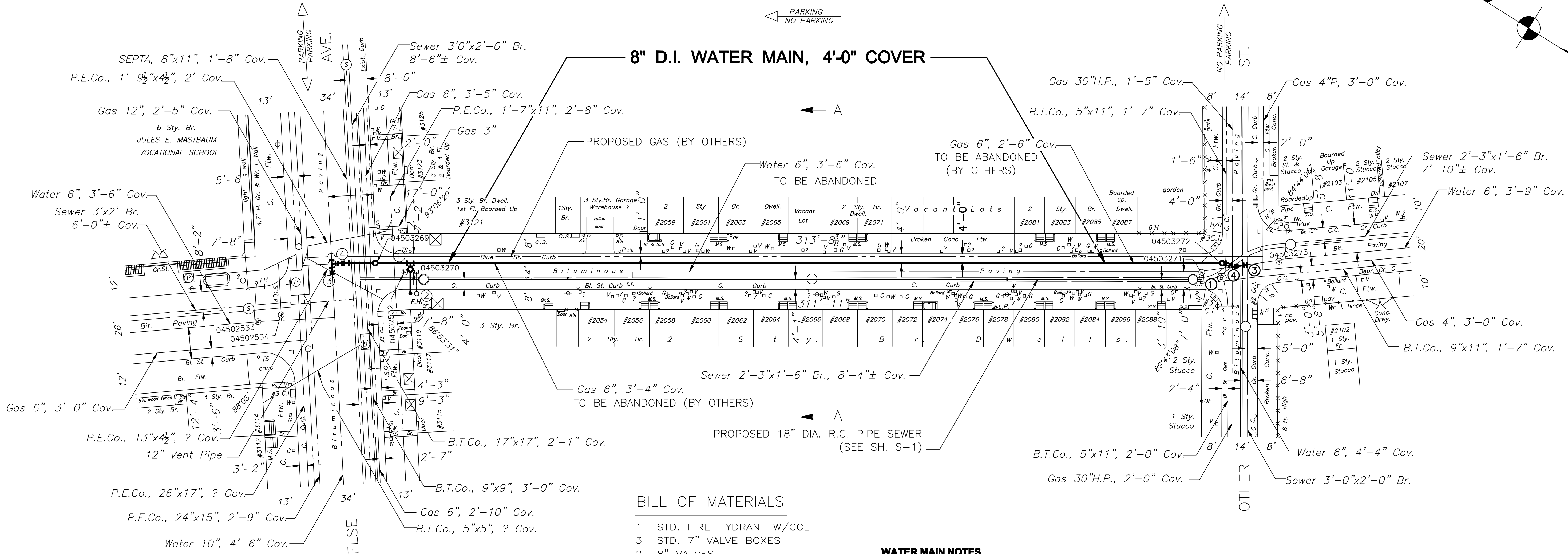

**BILL OF MATERIALS**

- 1 STD. FIRE HYDRANT W/CCL
- 3 STD. 7" VALVE BOXES
- 2 8" VALVES
- 1 6" VALVE
- 1 10"x8" TEE
- 1 8"x6" HYD. ANCH. TEE
- 3 8" 1/8 BENDS
- 1 8" 1/32 BEND
- 1 8"x6" REDUCER
- 2 10" SLEEVE
- 1 6" SLEEVE

**PIPE TOTALS**

- 5± 10" DUCTILE IRON WATER MAIN
- 355± 8" DUCTILE IRON WATER MAIN
- 15± 6" DUCTILE IRON WATER MAIN

**WATER MAIN NOTES**

1. ALL WORK TO BE DONE IN ACCORDANCE WITH THE CITY OF PHILADELPHIA WATER DEPARTMENT "WATER MAIN STANDARD DETAILS & CORROSION CONTROL SPECIFICATIONS", 1985 EDITION.
2. THE CONTRACTOR PERFORMING THE WATER & SEWER INSTALLATION MUST BE PREQUALIFIED BY PWD. CONTACT MR. BRIAN MOHL OF THE PROJECTS MANAGEMENT UNIT AT (215) 685-6339.
3. THE APPROVED WORK SHALL BE DONE IN THE PRESENCE OF A PWD INSPECTOR.
4. THE CONTRACTOR PERFORMING THIS WORK IS TO NOTIFY THE PWD CONSTRUCTION DIVISION, 1101 MARKET STREET, 2ND FLOOR, PHONE (215) 685-6345, AT LEAST 7 DAYS IN ADVANCE FOR ASSIGNMENT OF AN INSPECTOR TO THE JOB. WATER SHUT-OFF TO BE REQUESTED BY THE INSPECTOR ONLY.
5. THE CONTRACTOR MUST PROVIDE OFFICE SPACE FOR USE BY THE PWD INSPECTOR DURING CONSTRUCTION OF THE WATER MAIN.
6. ALL MATERIALS AND SUPPLIERS LIST MUST BE SUBMITTED TO THE WATER DEPARTMENT CONSTRUCTION BRANCH FOR APPROVAL.
7. APPROVAL OF THESE PLANS BY THE WATER DEPARTMENT IS STRICTLY LIMITED TO THE DESIGN OF DUCTILE IRON WATER MAINS 8 INCHES IN DIAMETER AND ABOVE SHOWN WITHIN THE LIMITS OF THE CITY OF PHILADELPHIA PUBLIC RIGHT OF WAY.
8. CONTACT MR. RICHARD WILLIAMS, PWD-WATER MAIN RECORDS, 1101 MARKET STREET, 2ND FLOOR, PHONE (215) 685-6270, FOR ADDITIONAL APPROVALS AND PERMITS REQUIRED FOR ALL WATER SERVICES, METERS AND CONNECTIONS TO THE EXISTING AND/OR PROPOSED PWD FACILITIES.
9. THE CONTRACTOR OR ENGINEER IS RESPONSIBLE FOR OBTAINING ALL ADDITIONAL PERMITS AND APPROVALS FROM ALL AFFECTED CITY AGENCIES AND UTILITIES.
10. CORROSION CONTROL STUDY IS NECESSARY FOR ALL DUCTILE IRON PIPES. WHEREVER EXISTING CORROSION CONTROL OF WATER MAINS IS DISTURBED, IT MUST BE RESTORED AND INSPECTED TO THE SATISFACTION OF THE PHILADELPHIA WATER DEPARTMENT. INSPECTION OF NEW CORROSION CONTROL SYSTEMS WILL BE PAID BY THE DEVELOPER.
11. THE ABANDONED WATER MAIN VALVE FRAMES AND FIRE HYDRANTS SHALL BE REMOVED AND DELIVERED INTACT TO PHILADELPHIA WATER DEPARTMENT AT 29TH & CAMBRIA STREETS.
12. FIRE HYDRANTS SHALL NOT BE CONSTRUCTED OR RELOCATED UNTIL SUCH EQUIPMENT AND LOCATIONS HAVE BEEN APPROVED BY THE WATER DEPARTMENT CONSTRUCTION DIVISION IN THE FIELD. THE CONSTRUCTION OR RELOCATION OF SUCH FACILITIES WITHOUT THE ABOVE APPROVAL WILL BE DONE AT THE RISK OF THE CONTRACTOR.
13. ALL ACTIVE SERVICES ARE TO BE RECONNECTED TO THE NEW MAIN IN ACCORDANCE WITH THE PHILADELPHIA PLUMBING CODE.
14. "D" PERMITS ARE REQUIRED FOR ALL EXISTING CONNECTIONS THAT ARE TO BE ABANDONED.

**NOTES:**

- ① REMOVE FRAME & COVER - SEE WATER NOTES.
- ② REMOVE FIRE HYDRANT - SEE WATER NOTES.
- ③ REMOVE PIPE AND/OR FITTING & RECONNECT.
- ④ ROTATE FITTINGS AS REQUIRED.

PREPARED BY: \_\_\_\_\_  
 \_\_\_\_\_  
 CONSULTANT'S NAME

SAMPLE DRAWING ONLY

**NOTICE**

PURSUANT TO THE REQUIREMENTS OF PA ACT 287 OF 1974 (THE UNDERGROUND UTILITY LINE PROTECTION ACT), AS AMENDED BY PA ACT 199 OF 2004, THE CONTRACTOR SHALL CONTACT THE PENNSYLVANIA ONE CALL SYSTEM AT 811 OR 1-800-242-1776, 3 TO 10 WORKING DAYS PRIOR TO EXCAVATION.

HIGHWAY DISTRICT NO. \_\_\_\_\_ WARD NO. \_\_\_\_\_  
 SURVEY DISTRICT NO. \_\_\_\_\_ WATER PLAT NO. \_\_\_\_\_  
 ONE CALL NO. \_\_\_\_\_

**PRIVATE COST WATER MAIN**

ANY STREET  
 FROM  
 OTHER STREET TO ELSE AVENUE

APPROVED \_\_\_\_\_  
 CONSULTANT'S COMPANY NAME  
 APPROVED \_\_\_\_\_  
 GENERAL MANAGER, PLANNING & ENGINEERING  
 APPROVED \_\_\_\_\_  
 WATER COMMISSIONER  
 WORK NO. W- \_\_\_\_\_ - C  
 SHEET NO. W-1 OF 1

CITY OF PHILADELPHIA  
 WATER DEPARTMENT  
 SCALES:  
 PLAN 1"=20'  
 AND AS SHOWN

DRAWN BY _____	PROJECT ENGR. X. XXXXX
SUPERVISOR _____	DATE _____

**GENERAL NOTES:**

1. CONTACT THE STREETS DEPARTMENT, AT LEAST TWO WEEKS PRIOR TO CONSTRUCTION, FOR THE FOLLOWING:

HIGHWAY OCCUPANCY PERMIT:	JOSEPH KISIEL RIGHT-OR-WAY UNIT 1401 JFK BLVD, MSB-940 PHILADELPHIA, PA 19102-1685 (215) 686-5097 FAX (215) 686-5062
PAVING & TRENCH RESTORATION PROCEDURE:	NANCY SEN PROJ. & PROGRAMMING DIRECTOR (215) 686-5907
LANE CLOSURE PERMIT:	DWAYNE BOWENS STREETS TECHNICAL SERVICES OFFICER TRAFFIC ENGINEERING 1401 JFK BLVD, MSB-980 PHILADELPHIA, PA 19102-1685 (215) 686-5525 FAX (215) 686-5067

2. STEEL PLATE FOR DECKING
  - A. DURING WORKING HOURS ESTABLISH AND MAINTAIN TRAVEL LANES USING STEEL PLATES AND FLAGMEN AS NECESSARY TO ALLOW THROUGH TRAFFIC. DURING NON-WORKING HOURS, BACKFILL OR DECK WITH STEEL PLATES ALL EXCAVATIONS.
  - B. ALL STEEL PLATE SHALL BE ADEQUATELY SECURED TO THE SURFACE TO PREVENT LATERAL MOVEMENT AVOIDING AN UNSAFE CONDITION.
  - C. THE SIZE OF THE STEEL PLATE SHALL BE LARGE ENOUGH TO SPAN THE OPENING, BE FIRMLY PLACED TO PREVENT ROCKING AND SHALL OVERLAP THE EDGES OF TRENCHES AND OPENINGS AND BE SUFFICIENTLY RAMPED TO PROVIDE SMOOTH RIDING AND SAFE CONDITION.
  - D. WHERE DEFLECTIONS ARE MORE THAN 3/4", HEAVIER SECTIONS OF PLATES OR IMMEDIATE SUPPORTS SHALL BE INSTALLED.
  - E. PRIOR TO PLACING ANY STEEL PLATING, THE CONTRACTOR SHALL PROVIDE THE RIGHT OF WAY UNIT OF THE DEPT. OF STREETS INSPECTOR WITH AN EMERGENCY TELEPHONE NUMBER IN THE EVENT ANY STEEL PLATING OR DECKING IS DISLODGED. UPON NOTICE FROM THE CITY, THE CONTRACTOR SHALL REMOVE OR RESTORE ANY DISLODGED STEEL PLATING OR DECKING TO A SAFE CONDITION WITHIN SIX HOURS UPON RECEIPT OF NOTICE BY THE CITY. IN THE EVENT IT BECOMES NECESSARY FOR THE CITY TO RESTORE OR REMOVE ANY STEEL PLATING OR DECKING, THE CONTRACTOR SHALL REIMBURSE THE CITY FOR ALL COSTS.
  - F. THE LOCATION OF ANY STEEL PLATE REMAINING IN THE PUBLIC RIGHT OF WAY FOR MORE THAN 72 HOURS MUST BE REPORTED TO THE STREETS DEPARTMENT DURING BUSINESS HOURS AT (215) 686-5501.

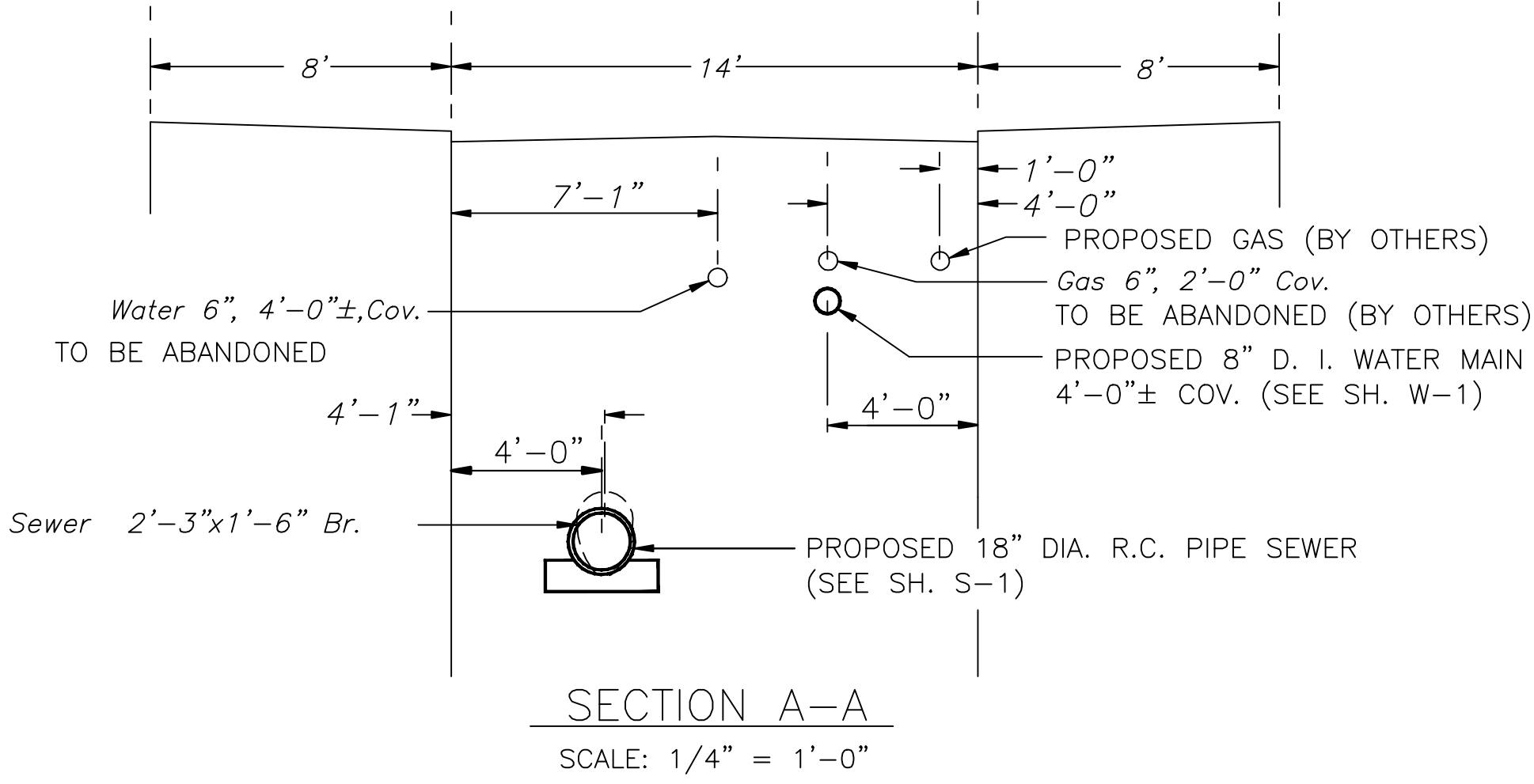

**SECTION A-A**

SCALE: 1/4" = 1'-0"